



GLIDER 2023+

BLUEWAVE INFLATABLE KAYAKS

INSTRUCTIONS OF USE AND OWNER'S MANUAL

**Your kayak design, valve and pump may visually differ from the images in this manual. Please be assured the instructions remain the same.*

DON'T FORGET TO SEND US PICTURES FOR A CHANCE TO WIN AWARDS IF WE USE YOUR PHOTOS ON OUR WEBSITE!

ABOUT US

Bluewave has been manufacturing kayaks for many years and are a well known supplier of rigid leisure kayaks across the UK. The Bluewave Team loves getting out on the water, whether in a hard hulled or inflatable kayak, a paddle board or iSUP, and strive to provide the best equipment on the market to enable others to do the same. Our sense of adventure and enthusiasm for the industry is ever growing. We work with the highest grade materials and construction techniques to provide cutting edge, durable watercraft. Our products come with a standard 12 month warranty against manufacturing defects.

CONTACT US

We are a family run business and hold to the ideals of our founder. We recognise the value of each and every one of our customers, and wish to reciprocate the support given to us by remaining accessible and contactable to chat through concerns, questions or special requests when ordering.

PRODUCTS

Model: BLUEWAVE Glider 2+1 Seater
Dimensions: 15'5" x 29" / 471cm x 76cm
Weight: 18kg
Max Load Capacity: 700lbs / 317kg
Style: Double, Touring, Inflatable
Inflation Time: 7 Minutes
Production: 2023+

INFLATE TO 10PSI - ALL CHAMBERS

WARRANTY: 12 months warranty against manufacturing defects.

SAFETY - WARNING
THESE KAYAKS HAVE NOT BEEN DESIGNED FOR WHITE WATER USE.

SAFETY GUIDE

NEVER ALLOW CHILDREN TO USE THE GLIDER INFLATABLE KAYAK WITHOUT SUPERVISION.

Kayaking or canoeing is one of the most popular sports in the UK and Ireland. Water safety should be paramount from the moment you consider going out on the water in any craft. Regardless of whether you are a seasoned pro or novice, familiarise yourself with potential risks and water safety procedures so you can paddle safely. As the popularity of kayaking and paddle based sports has increased, so have the number of rescue incidents reported. In many cases, paddlers were unable to call for help themselves.

STAYING SAFE – Always carry a means of calling for help and keep it within reach. Phones should be carried in water tight cases within easy reach NOT locked in storage compartments. Consider carrying alternative communication devices and flares if you are going some distance off shore.

Remember not all coastal areas have a mobile phone signal so consider other means of communicating should you get into any difficulty such as a waterproof VHF radio, Personal Locator Beacon (PLB), GSM tracker with a SOS function. Other safe practices include:

- Wearing a floatation device.
- Checking weather and tides.
- Telling someone where you are going and when you will be back.
- Don't paddle alone.
- Always carry drinking water and snacks.
- Wearing appropriate clothing for the conditions. Be aware of hypothermia and store additional waterproof and warm clothing for your trip in a dry bag. Wear a wetsuit or drysuit if warranted.
- Using sunscreen.
- Carrying a waterproof first aid kit.
- Carrying a tow line, whistle, spare floatation device, flares and drybag.
- **UNDERTAKING TRAINING:** Contact your local canoe club. You can get coaching sessions and training from the British Canoeing Club - <https://www.britishcanoeing.org.uk>.

REMEMBER: Some waterways require a licence – check before setting out.

ALWAYS CHECK YOUR CRAFT BEFORE VENTURING OUT ON WATER. Check your equipment is ready for the water and has adequate buoyancy if capsized before setting out. Whilst this craft is extremely durable and hardy, it is always best to make sure you are carrying your repair kit and a mobile pump.

CE

Product: INFLATABLE KAYAK

Model(s):

Length: 2850mm-6000mm,

width: 700mm-1000mm,

height: 200mm-700mm

Verification to: Standard:

EN 15649-1:2009+A2:2013

related to CE Directive(s):

2001/95/EC (General Product Safety)



INCLUDED ACCESSORIES

Glider 2 Seater:

1 X PUMP, 2 X SEATS, 1 X SKEG (FIN),

2 X PADDLES, 2 X FOOTRESTS,

1 X ROLLER BAG, 1 X REPAIR KIT



FEATURES

The double layer dropstitch construction allows for inflation to 10PSI. This construction enables overall rigidity to be increased. Bluewave Sports inflatable kayaks are not going to fold in half the moment they come into contact with surf and are as rigid as any kayak in their class.

The hull features tapered dropstitch walls creating secondary buoyancy and stability, and providing a rigid chine at the waterline. The double concave design at the bow allows for air pockets to form between the hull and water, creating lift while reducing friction and drag. The bow is tapered and formed with moulded plastic creating a smooth entry through the water. The Glider has a high degree of manoeuvrability, with superior length to width ratio, razor sharp bow entry, straight-line planing and a sharp stern exit.

Please note: the Glider 2 Seater kayak is versatile, designed as both a tandem kayak and for individual use. With multiple D rings placed strategically along the interior of this vessel, two kayak seats can be fitted at either end, or alternatively one seat can be installed at the centre of the inflatable kayak.

INSTRUCTIONS OF USE

VALVES



The Bluewave Glider has a recessed valve for each side chamber and the floor [1]. Remove the cap by twisting to access the valve. The button in the middle of the valve has two positions - to let the air in or out. Click the button to change the function. When the button is sticking up, it is set for inflation. This mode also keeps the air inside the chamber. To deflate, push the button down. Before next inflation, push the button again to change to inflation. After finishing, reattach the valve cap.

PUMP

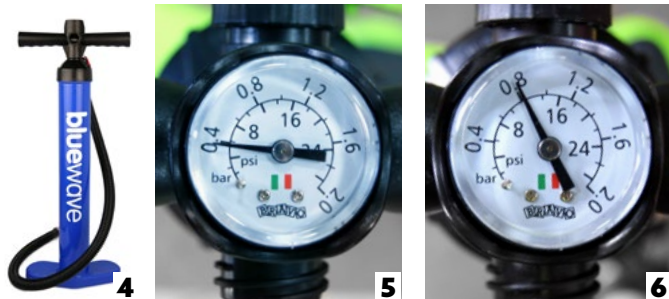

Maximum air pressure for this model is 10 PSI [6]. In extremely warm weather you may wish to let some of the air out when not using to allow for hot air expansion. AVOID over inflation as this will lead to your warranty being declared invalid.

The high volume pump comes with a pressure gauge and an inflate inlet. The pressure gauge will not move until you have reached the minimum PSI [5]. You should feel the resistance in the pump when you start to reach the correct PSI. The highest recommended 10 PSI pressure will achieve the best performance in your kayak.

The pump has both inflation and deflation modes, depending on which side you are using. The mode sides are identified above the air outlet.



DRAINS

Drains are a convenient way to empty accumulated water from paddle splash and rain. Only open drains on shore. **WARNING** Drains are not intended for use while on water.

INFLATION



Choose an area large enough to unfold [8] the Glider, ensuring the space is free of hazards which could damage the kayak or cause injury. You can inflate the sides or floor in any order. The working pressure for walls and floor is 10 PSI [12].

The front of the kayak can be identified by the closest sets of D-rings to the splash guards - they are positioned lower down. The back of the kayak is the end with the drainage.



14



SEAT(S)

Attach the seat(s) by clipping the seat connectors to the D-rings [15-18]. The top connectors attach to the forward D-rings and the lower seat straps connect to the rear D-ring connectors. You have been provided with an extra cushion block which is attached by Velcro to the bottom of the seat [20]. To see if the seat is at the right height, place your weight on the seat, push your lumbar region into the backrest by arching your back forward, then sit up straight. You want to feel supported and steady. If you are using the cushion block and the seat is slipping or moving around, then the seat is set too high and the cushion block needs to be removed [21]. The seat should be set and adjusted to give you the best support and balance whilst paddling. You have been provided with a foam foot rest(s) which can be attached to the low set D-rings for additional support [19].

The double Glider can accommodate two seats, or alternatively have one centred in the middle of the kayak for single use.

To install two seats, the seat connectors need to be attached to the D-rings that sit higher on the kayak sides. Once the seats have been fitted in place, there will be two sets of D-rings left over, located lower down and positioned in front of each seat. These are for the footrest attachments.

To install the singular seat in the Glider 2 Seater, we recommend positioning it in the centre of the boat, and clipping the top connectors to the 3rd D-rings and the lower seat straps to the 5th D-rings down from the bow (front) of the boat.

The single Glider kayak only features three (3) pairs of D-rings. The kayak seat connectors will need to be attached to the two sets of D-rings that are located higher up on the sides of the inflatable. The low set D-rings indicate where the foot rest can be fixed.

SKEG/FIN

Turn the kayak over and slide the skeg/fin into the base [22-24]. It will only slide in one way. Slide the locking tab into its groove until it clicks into place [25-27].

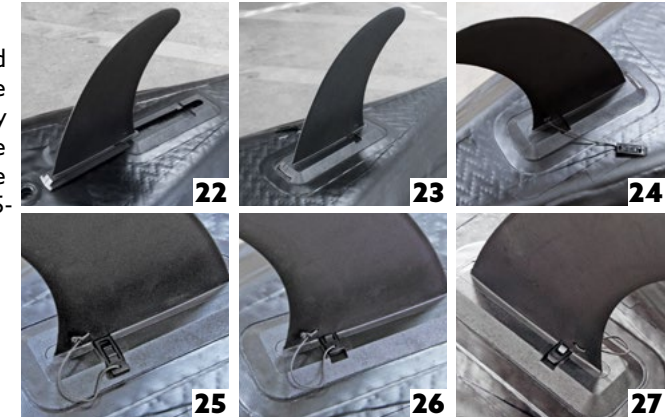

PADDLE

Assembly for the paddle is straight forward. Connect the four parts of the paddle by first linking the ends of the paddle with the middle pieces, and then connect the half of the paddle with the push pin into the paddle half with the hole.



DEFLATION

Make sure that the kayak is fully dry before folding and stowing.

Remove all seats, skeg/fin etc. [31] Push down on the valve stem. The valve will stay in the down position allowing the air to escape [32].



WARNING: DO NOT PLACE FACE DIRECTLY OVER VALVE AS AIR ESCAPES AT FORCE AND COULD BE DANGEROUS.



Once you have deflated the kayak, fold the walls over the base so the kayak is ready for a compact, tight fold [34]. Always make sure the skeg/fin slide base is pushed down flat to prevent it from bending and becoming misshapen.

Fold both ends towards the middle of the kayak, leaving just enough gap to fold again comfortably.

PROTECTION FROM HEAT

Avoid leaving the boat in direct sunlight when ashore. Temperatures on a beach, dock, davit, etc. can get very high, which could affect the vinyl or glue. Excessive exposure to sun and heat can cause your Glider to become sticky or cause the glue to fail.

STORAGE

The best way to store your inflatable kayak is dry in its bag. Always check for water in chambers when you are folding your kayak. Dry thoroughly to prevent mould developing during storage. Keep in a dry, cool storage area. Avoid direct sunlight, attics and metal sheds.

REPAIRS



Your Glider is supplied with a repair kit which includes glue, mixing spoon and patching material.

We use a PVC glue specifically for PVC boats. Epoxy, waterproofing sprays and Gorilla Glue do not work.

TIP: The smaller the patch, the easier the repair. Most repairs fail due to the patch being too big.

TIP FOR FINDING A LEAK: You'll need a bucket and washing up liquid. Fill the bucket with clear water and add a good squirt of soap (couple of tablespoons) to the water. Inflate the leaking chamber to full pressure. Spread lots of soapy water on the leaking chamber with a hand towel or large sponge. Don't assume the leak is coming from the valve or seams. The leak may produce bubbles, make hissing or sputtering noises, or spray water.

Once you have located the leak you can judge the size of the patch required. Use a coin as a template, mark its outline on the patching material and cut out a patch using a scalpel or sharp scissors.

Take the same template, trace an outline on some masking tape and cut this shape out with a scalpel. Place the masking tape with the cut out section over the puncture on the kayak with the puncture in the centre of the cut out. This is now your guide for placing the patch.

Once you have glued the patch to the boat, remove the masking tape immediately and smooth the patch with a finger to remove any air bubbles. Heat the patch with a hair dryer for 10-20 seconds and smooth again.



BLUEWAVEKAYAKS.COM

BLUEWAVE SPORTS

Unit 3, Woodlands Business Park,
Burlescombe, Devon, EX16 7LL
enquiries@bluewavekayaks.com
Telephone: +44 (0) 1823 672970